

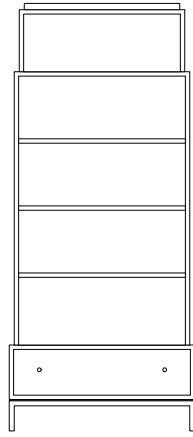

VILLA TOWER II
37W X 16D X 85.25H

HONNING.US



VILLA TOWER II

Dimensions: 37W X 16D X 85.25H

Materials: Quartered Ash, Mahogany, or Walnut
Bronze Patina on Steel
Dark Bronze pulls

Designed by: Maxine Snider

Description: The Villa Tower II is our original Villa bookcase re-proportioned and detailed with metal. It's a taller, slimmer version of the first, with an elegant steel base in a bronze patina. We love the new grace of it, the mix of materials, and its many uses. Books, towels, dishes, collections---you name it, the Villa Tower II stores it in style.

SUGGESTED VARIATIONS

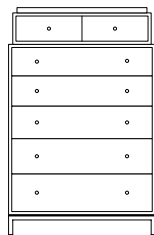

Chest of Drawers

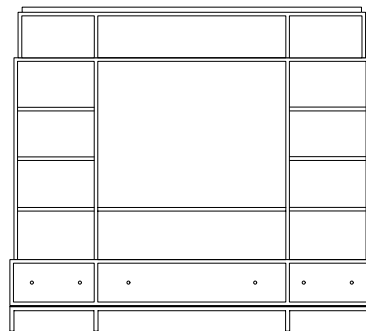

Entertainment Center

HONNING

3932 N. Elston Ave. Chicago, IL 60618
+1 773.654.3777 info@honning.us www.honning.us