

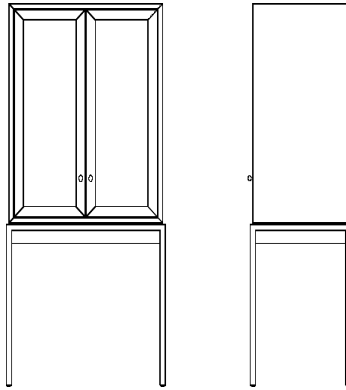

*Bar interior*

HUGO CABINET  
30W X 19D X 66H  
HONNING.US



## HUGO CABINET

Dimensions: 30W X 19D X 66H

Materials: Ash, Oak or Walnut  
Brushed or polished stainless steel, brushed or polished bronze,  
bronze patina on steel; English reeded or clear glass

Designed by: Bridgette Buckley

Description: This contemporary 'cabinet on stand' is scaled for the human body. The ritual of engaging with it is rich and inviting. Available in two standard interior options: vitrine has two adjustable glass shelves and a lower leather surface; or bar which has a leather-lined pull out tray, drawer and stem-ware rack accommodating up to 15 standard glasses. Interior lighting is available a la carte. Hugo means "bright in mind and spirit", and this cabinet will allow collections or favorite imbibements to shine.

### SUGGESTED VARIATIONS

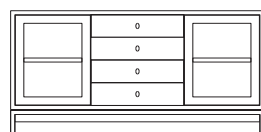

buffet

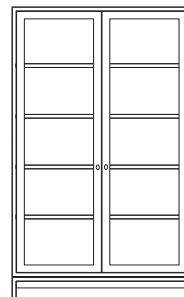

bookcase

## HONNING

3932 N. Elston Ave. Chicago, IL 60618  
+1 773.654.3777 info@honning.us www.honning.us