

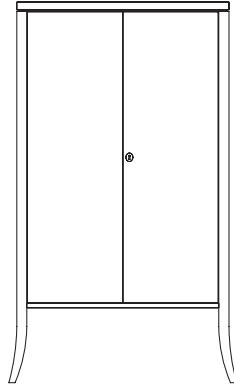

CLASSIC ARMOIRE
34W X 18D X 61H

HONNING.US



CLASSIC ARMOIRE

Dimensions: 34W X 18D X 61H
34W X 24D X 61H

Materials: Cherry or Mahogany
Faux Ivory escutcheon with Brass keyhole

Designed by: Maxine Snider

Description: The Classic Armoire's spare elegance belies its infinite functions. Outfitted variously to hold linens, tableware, clothing, or multimedia equipment, this versatile and graceful cabinet provides myriad storage options behind its matched mahogany doors, locked by the collection's signature ivory escutcheon and brass key.

INTERIOR VARIATIONS

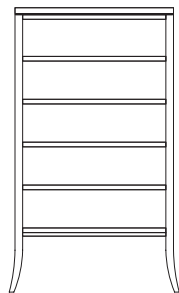

Linen

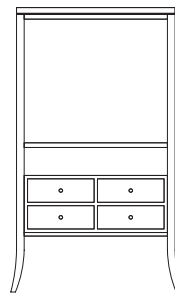

Media

HONNING

3932 N. Elston Ave. Chicago, IL 60618
+1 773.654.3777 info@honning.us www.honning.us